



 **ELEVATE**
HIS CHURCH. OUR FUTURE.

ST. WENCESLAUS CATHOLIC CHURCH
OMAHA, NEBRASKA

ELEVATE CAMPAIGN
2020-2023



Dear Friend in Christ,

We officially announced the **ELEVATE** capital campaign in December, and we hope that you have been able to take some time to read through the previous two newsletters to familiarize yourself with the campaign, why it's important for the St. Wenceslaus community, and the role you can play in its success. (To review previous newsletters, visit st.wenceslaus.org and click on the **ELEVATE** campaign logo.)

This newsletter provides the most comprehensive explanation of our plan. It includes detailed information about anticipated projects, costs and campaign goals. We have also included FAQs to address your questions, as well as other important information for your thoughtful consideration and prayer.

As I watch our new church being built, I am so grateful that we will continue to positively impact the lives of countless parishioners through our ministries and outreach services. **We are truly answering His call to ELEVATE our parish and community toward the future.**

Together, we will write another chapter in the proud history of St. Wenceslaus.

Yours in Christ,



Fr. Tom Bauwens
Pastor



“Together, with God’s help, through faith, prayer and generosity, we will write another chapter in the proud history of St. Wenceslaus.”

ELEVATE CHAIRS

Rita & Steve Bartlett
Gary & Kathy Gates

Jeff & Lauren Green
Liz Jonas

Eric & Staci Mueller

St. Wenceslaus has a long and proud history of sharing and living our Catholic faith. Originally founded in 1877 and relocated to West Omaha in 1980, it has grown to more than **3,200 households** in our church family, **900 students** in our school and **400 children and adults** in our religious education programs. Approximately 3,500 parishioners and guests currently celebrate at one of our seven Masses each weekend.

With continued growth projected in the future, we’re so grateful that our new church will accommodate more than 1,400 people, and serve as the spiritual home for future generations. But this major investment in the life of our parish comes with a price tag that is too big to overcome without a capital campaign.

The **ELEVATE** campaign aims to accomplish the following financial goals:



GOAL #1: **Celebration – \$5 Million**

If we reach the goal of \$5 million, we will save \$2,630,000 in interest.

GOAL #2: **Challenge – \$8 Million**

If we reach the goal of \$8 million, we will save \$4,481,000 in interest.

GOAL #3: **Challenge-Plus – \$12 Million**

If we reach the goal of \$12 million, we will save \$6,949,000 in interest.

GOAL #4: **Transformation – \$16 Million**

If we reach the goal of \$16 million, we will save \$7,566,000 in interest.

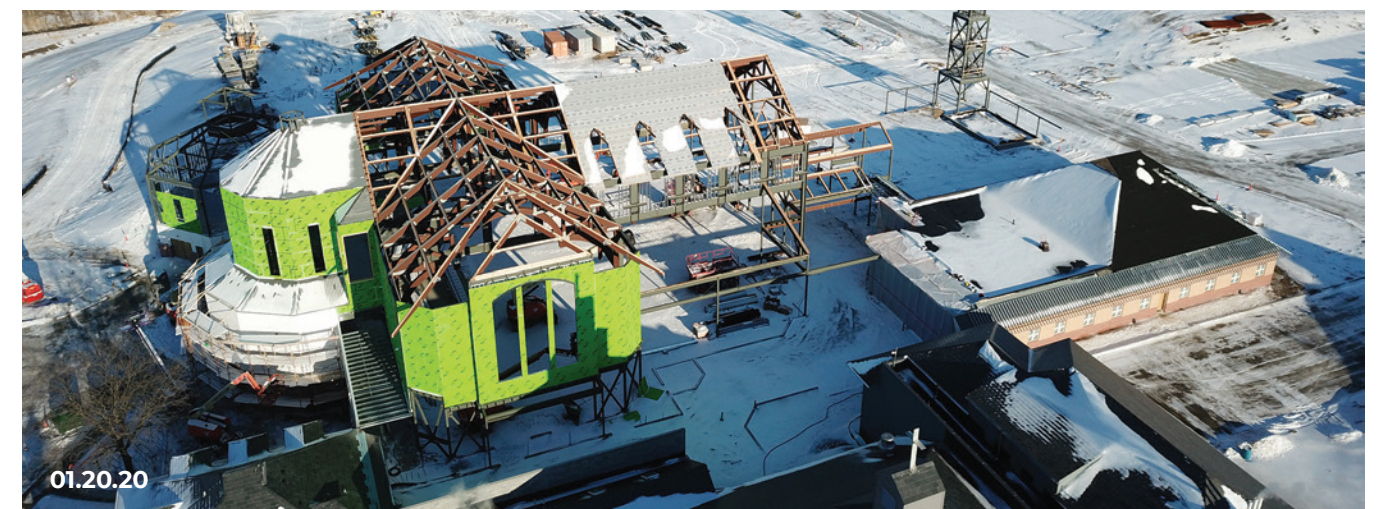

Specifically, we have identified four areas for which the campaign funds are needed:

1

Complete the construction of our new church

2

Pay off the loans for the church, land, school improvements and parking

3

Put our parish in a position of financial strength

4

Prepare for future members and ministry

Please prayerfully consider your role in this important project!

PREVIOUS CAMPAIGN HISTORY & FUTURE CAMPAIGN GOALS

Revenue History of the Ignite the Faith Campaign (2015-2018)

Campaign Pledge Total:	\$7,107,000
Building Savings Account:	\$402,000
TOTAL REVENUE:	\$7,509,000

Allocated Projects from Campaign Funds

School Addition Costs:	(\$3,300,000)
Endowment & Church Improvements:	(\$900,000)
Campaign Contributions to the Archdiocese:	(\$2,300,000)
Administrative & Campaign Expenses:	(\$200,000)
REMAINING FUNDS:	\$809,000

Financials from New Church & Campus Expansion

Cost for the New Church & Parish Offices:	\$31,600,000
Administrative Costs & Campaign Expenses:	\$200,000
Sponsored Expenses:	(\$3,991,000)
The Eileen Ryan Gift:	(\$10,000,000)
Endowments:	(\$1,300,000)
Balance from Previous Campaign:	(\$809,000)
APPROVED LOAN:	\$15,700,000

Jesus calls His disciples to love and serve.
This God-sized vision is too much for us as individuals, but it's not too much for the Holy Spirit as He lives and works in us. Together, and with God's help, let us boldly answer His call that we may do great things, serve faithfully and continue our rich legacy for future generations.

FREQUENTLY ASKED QUESTIONS ABOUT THE ELEVATE CAMPAIGN

Q: Why are we building a new church?

A: We are building for the future of St. Wenceslaus. When our current church was built in the early 1980s, it was designed to accommodate 900 registered parishioners/families. Today, we have over 3,400 registered households, and we're expected to grow by at least another 1,200 households in the next 10 years. With the potential of fewer mass times with fewer priests, we are also building a church that will accommodate these changes well into the future.

Q: How many people will the new church be able to accommodate?

A: Our new church will accommodate 1,400 parishioners, a significant increase from our current seating of 850. The new church also features a day chapel that will accommodate an additional 200 parishioners. It will be a place for quiet reflection, prayer, smaller masses and additional prayer services.

Q: Why are we building new parish offices?

A: While planning for our parish expansion, we received input from our parishioners about the need for more meeting spaces and accessible offices for those who have disabilities. Our current parish office is multileveled and has only one of these types of meeting rooms. The new parish offices will have three meeting rooms, 17 employee offices and an additional meeting space like our current Community Room. These meeting and office spaces will be fully accessible to meet the needs of our parishioners.

Q: Why a second campaign?

A: On the previous page, we have outlined where the funds during the last campaign, *Ignite the Faith for Future Generations*, were allocated. Since this last campaign was a combined effort with the Archdiocese, a significant portion went toward our archdiocesan goal. One-hundred percent of the money raised through the **ELEVATE** campaign will be used toward our building loans for our new church and parish offices.

Q: Will new parishioners who join us in the future be asked to participate in **ELEVATE**?

A: Yes, we will continue to ask for the financial and spiritual support from our newest parishioners.

Q: What is the projected timeline for the completion of the parish offices and church?

A: According to the most recent report from Boyd Jones, we are on schedule to move into the parish offices in November 2020 and our new church in June 2021.

Q: What will we do with our existing church?

A: Our goal is to convert it into a parish center for funeral luncheons, Donut Sundays, wedding receptions and various parish functions. Father Tom is looking for a donor to specifically underwrite this project, as our first priority during **ELEVATE** will be to pay down the loans for the new church and parish offices.

Q: What is expected of me during this campaign?

A: We ask that all of our parishioners join us in praying the **ELEVATE** Stewardship Prayer. We also ask that you prayerfully consider making a sacrificial pledge over the next three years to help us reach our financial goals. We hope you will respond with generosity and sacrifice just as generations before us have done. We want to position St. Wenceslaus for further growth, ministry and financial strength for years to come.

GO HIGHER, GO FARTHER!

God is calling us to something monumental, to the building of a beautiful new church, to a once-in-a-lifetime involvement. And it will take God’s help and our collective sacrifices to accomplish this. Some have been given little so they can share little; some have been given much so they can share much. But all of us can give like kings if we give sacrificially!

To start thinking about your sacrificial gift, seek to do the following:

- 1. Review the gift scale.
- 2. Consider the manageable three-year gift that you think you can make.
- 3. Now, consider a sacrificial gift. That is, consider going one or two levels higher: from the more comfortable level to the more sacrificial level.
- 4. Think of the generous example of your grandparents and pray, “Lord, what do you want to do – through me – for my parish?”
- 5. Let the Holy Spirit lead you to a place that is satisfying and sacrificial!
- 6. The only way most of us can go one level higher is by:
 - Giving something up for a while, or
 - Putting off purchasing something for a while

GIFT SCALE		
Monthly	Yearly	3-yr Pledge
\$13,889	\$166,667	\$500,000
\$11,111	\$133,333	\$400,000
\$8,333	\$100,000	\$300,000
\$6,944	\$83,333	\$250,000
\$5,556	\$66,667	\$200,000
\$4,167	\$50,000	\$150,000
\$3,333	\$40,000	\$120,000
\$2,500	\$30,000	\$90,000
\$2,083	\$25,000	\$75,000
\$1,667	\$20,000	\$60,000
\$1,250	\$15,000	\$45,000
\$1,000	\$12,000	\$36,000
\$833	\$10,000	\$30,000
\$700	\$8,400	\$25,200
\$600	\$7,200	\$21,600
\$500	\$6,000	\$18,000
\$400	\$4,800	\$14,400
\$300	\$3,600	\$10,800
\$250	\$3,000	\$9,000
\$200	\$2,400	\$7,200
\$150	\$1,800	\$5,400
\$100	\$1,200	\$3,600
\$75	\$900	\$2,700
\$50	\$600	\$1,800

CONSIDER AN ESTATE GIFT

The dream of a new church, planted in our community by God himself, is a monumental undertaking. Very often people will say, “Father, enclosed is my pledge. I wish I could do more, but I have to also keep an eye on my future care needs as I get older.”

A great way to continue the mission of Jesus here at St. Wenceslaus is to consider an **estate gift** or **bequest**. By remembering St. Wenceslaus in your will, you can take care of your present and future needs AND continue the mission of Jesus here at our church.

These are some helpful ideas:

- **A will lets you distribute earthly gifts as you wish:** If you don’t have a will, the State of Nebraska has one for you.
- **A will gives you a say in how the church funds will be used:** Endowments, ministry funds, improvement funds, etc.
- **Estate gifts can offer tax benefits to donors:** For example, a bequest is 100% deductible from a donor’s estate and can reduce potential estate taxes.
- St. Wenceslaus’s legal title, for your reference, is:
St. Wenceslaus Catholic Church
15353 Pacific Street
Omaha, NE 68154
402-330-0304
- **Think of St. Wenceslaus as one of your children:** If you have two children, think of St. Wenceslaus as your third child; if you have five kids, think of St. Wenceslaus as your sixth child.
- **Residual:** You may also remember St. Wenceslaus through a residual of 5%, 10%, 20%, or more of your estate.

St. Wenceslaus has been and is a special Christian family. Together, we continue the mission of Jesus in West Omaha, now and in the future!



STRONGER TOGETHER

IMPORTANT UPCOMING DATES

February 22-23

Information Weekend 1 – Kickoff

Appeal information packets available at all Masses

February 29-March 1

Information Weekend 2 – Kickoff

Appeal information packets available at all Masses

March 7-8

Inspiration Weekend 1

March 14-15

Inspiration Weekend 2

March 16, 17, 19

Information Campaign Parties

March 21-22

Inspiration Weekend 3

March 28-29

Inspiration Weekend 4

April – June

Commitment Weekends continue

Campaign Celebration TBD



ST. WENCESLAUS PRAYER

Gracious and loving Father,
as we prepare to build for the future of Your church,
Guide us with Your strength and wisdom
as we come together to meet
the needs of Your people.
Without you we labor in vain,
yet with you we bear much fruit.

Bless our stewardship efforts during **ELEVATE**
as we build upon a vibrant faith in our families
and community, now and for future generations,
with Christ as our Cornerstone
and the Holy Spirit as our guide.

Amen

Our Lady of Grace, pray for us!
St. Wenceslaus, pray for us!



St. Wenceslaus by Cecilia Lawrence